

## Clamping pads

with female thread

### SPECIFICATION

#### Types

- Type **B**: Ball steel, smooth contact face
- Type **R**: Ball steel, serrated contact face
- Type **K**: Ball plastic, smooth contact face

Steel

- tempered
- Tensile strength class 10.9

Ball

Type B and R:

Steel hardened (54+2 HRC)

Type K:

Plastic (Polyacetal POM)

O-Ring

Rubber NBR (Perbunan®)



### INFORMATION

Clamping pads GN 709.7 are also used in jig and fixture construction, for example for clamping workpieces, as movable bearing surface or as stop. The swivel-mounted ball compensates uneven and non-parallel contact surfaces by as much as 10°. It is also secured against further twisting.

The O-ring holds the ball in position and prevents dirt from penetrating, resulting in a long service life and constant mobility.

### TECHNICAL INFORMATION

- Strength values of screws (see page A20)
- Plastic characteristics (see page A2)
- Elastomer characteristics (see page A32)

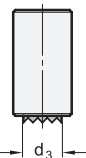
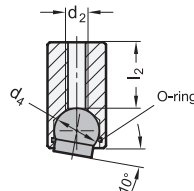
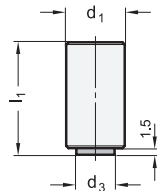

Application example of different clamping pads with O-ring

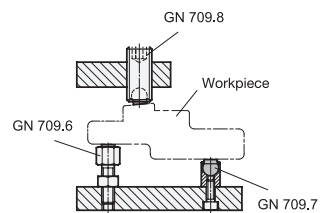

### GN 709.7

Description	d1 h9	l1 ±0.13	d2	d3	d4	l2	Static load max. in kN	⚖️
GN 709.7-10-12-B	10	12	M 4	6	7	4.1	12	7
GN 709.7-10-25-B	10	25	M 4	6	7	17.1	12	14
GN 709.7-13-16-B	13	16	M 5	8.5	10	5.7	20	15
GN 709.7-13-25-B	13	25	M 5	8.5	10	14.7	20	24
GN 709.7-10-12-K	10	12	M 4	6	7	5.6	2	5
GN 709.7-10-25-K	10	25	M 4	6	7	18.6	2	12
GN 709.7-13-16-K	13	16	M 5	8.5	10	7.2	4	12
GN 709.7-13-25-K	13	25	M 5	8.5	10	16.2	4	20
GN 709.7-10-12-R	10	12	M 4	6	7	5.6	6	7
GN 709.7-10-25-R	10	25	M 4	6	7	18.6	6	14
GN 709.7-13-16-R	13	16	M 5	8.5	10	7.2	9	15
GN 709.7-13-25-R	13	25	M 5	8.5	10	16.2	9	23